

FlexiTech Small & Large Uniform 400lm CG-S



Target group: Skilled electricians
Zielgruppe: Elektrofachkraft



Intended application: Emergency lighting, not suitable for private use.
Verwendungszweck: Notbeleuchtung, nicht für privaten Gebrauch.

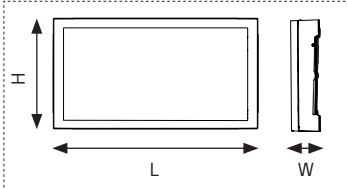

	Small	Large
L	231mm	326mm
H	86mm	178mm
W	34mm	38mm

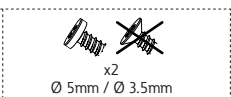
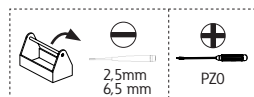
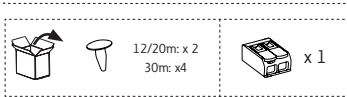
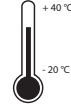

For working on the installation, please ensure first the emergency lighting system is blocked, the battery operation is interrupted, and the mains is OFF.

Stellen Sie bei Arbeiten an der Installation sicher, dass zuerst das Notbeleuchtungssystem blockiert, der Batteriebetrieb unterbrochen und das Stromnetz ausgeschaltet ist.

1

a

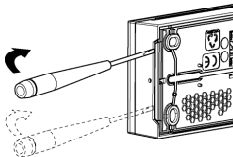
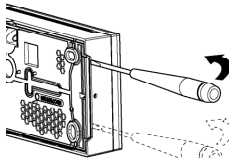

b

12M 37 mm 112 mm 33 mm
30M 46 mm 91 mm 44 mm

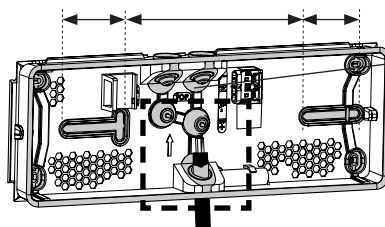

In order to ensure proper aging of the product, use one of the framed cable entries.
Verwenden Sie eine der gerahmten Kabeleinführungen, um eine ordnungsgemäße Alterung des Produkts zu gewährleisten.

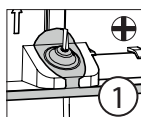

Break a cable entry by using a screwdriver.
Leitungseinführung mit einem Schraubendreher öffnen.

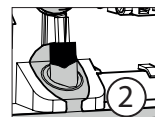

Rigid or flexible wire
Starres oder flexibles Leitungs
6 mm < Ø < 13,5 mm

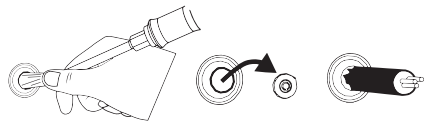

EATON

Powering Business Worldwide





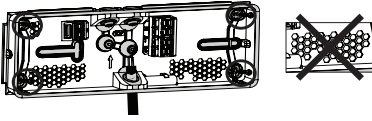

C

IP66:  x4 Ø 5mm



IP43:

 x4 Ø 3.5mm / 
 Ø 5mm
 OR  x2 Ø 3.5mm / 
 Ø 5mm

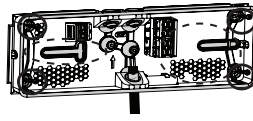

2

 2.5 mm

$S < 1.5 \text{ mm}^2$



Use screwdriver to place and remove wire
 Stecken und Entfernen der Leitungen mittels Schraubendreher

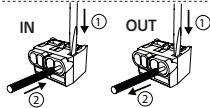

$1.5 < S < 2.5 \text{ mm}^2$



No screwdriver required for connection
 Stecken der Leitung ohne Schraubendreher möglich

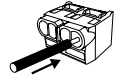

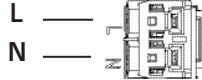

 min. 8 mm

220-240V AC - 50/60 Hz
 176-275V DC

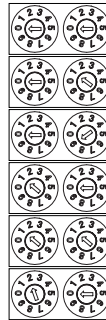
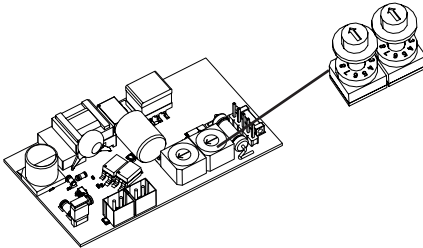

Max. 6A

Addressing/Adressierung



0 + 0 = No address (without CG-S monitoring)/
 Keine Adresse (ohne CG-S Überwachung)

0 + 1 = 1

0 + 9 = 9

1 + 0 = 10

1 + 1 = 11

2 + 0 = 20

Max. 20

Optional

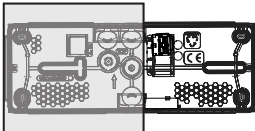
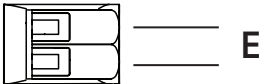

$0.5 < S < 2.5 \text{ mm}^2$

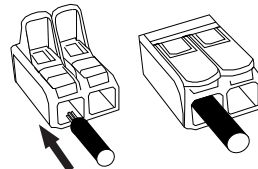

3

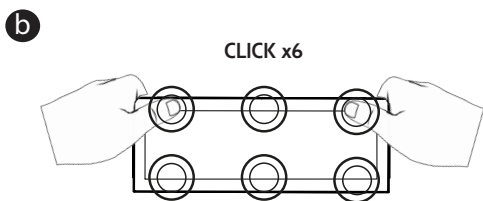
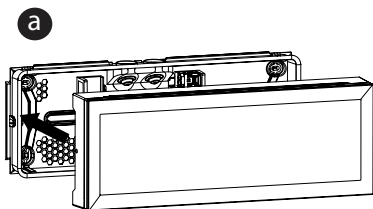

c 30M:

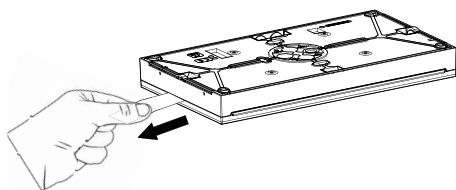

4

12m

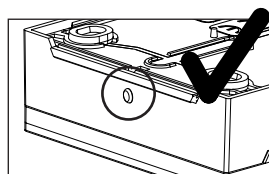
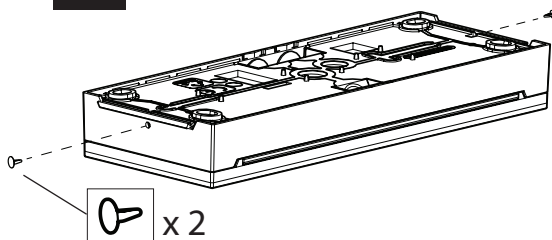

30m

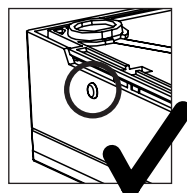
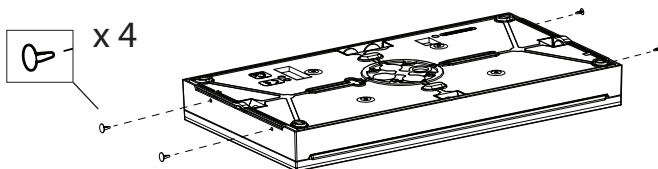

Power consumption mains operation
(apparent/effective power)
Anschlussleistung Netzbetrieb
(Scheinleistung / Wirkleistung)



EN

FT1SU400CGS	9.1VA / 5.4W	12m	IP43 / IK07	64 x LED 3V 600mA	400 lm	EN60598.1 EN 60598.2.22
FT1SU400CGSIP	9.1VA / 5.4W	12m	IP66 / IK07	64 x LED 3V 600mA	400 lm	
FT3SU400CGS	9.1VA / 5.4W	30m	IP43 / IK07	96 x LED 3V 600mA	400 lm	



Not replaceable
Nicht austauschbar

When the life time of light source is over, replace the luminaire.
Wenn das Lebensdauerende der Lichtquelle erreicht wurde, ersetzen Sie die Leuchte.

Eaton
Cooper Sécurité SAS
PEE II - Rue Beethoven - BP10184
63204 RIOM CEDEX FRANCE
Tél. +33 (0)825 826 212 (0,15 € TTC/min)
www.cooperfrance.com
www.eaton.com

Eaton
EMEA Headquarters
Route de la Longeraie 7
1110 Morges, Switzerland
Eaton.eu

© 2022 Eaton
All Rights Reserved



WEEE: Contact your local dealer

Eaton.com/recycling

ZNO2058400 B- 04/2022

Eaton is a registered trademark.

All trademarks are property
of their respective owners.



EATON

Powering Business Worldwide